

PLAN 24" X 45 1/4" TYPE S INLET TOP  
39 1/2" X 57 1/4" X 18"

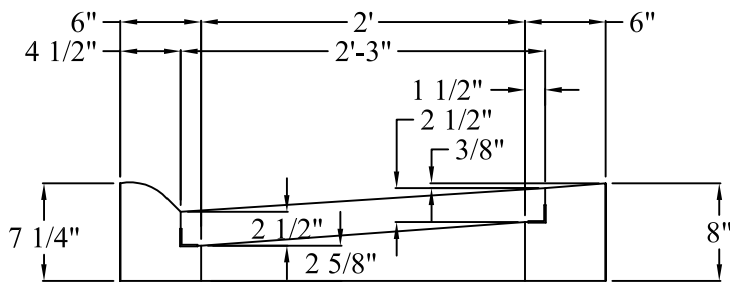

**SPECIFICATIONS**

MATERIAL AND CONSTRUCTION SHALL COMPLY WITH PENN D.O.T. PUB. 408  
CLASS AA CONCRETE 4000 P.S.I. @ 28 DAYS  
REINFORCEMENT~ A.S.T.M. A615 GRADE 60, MIN. 1 1/2" COVER.

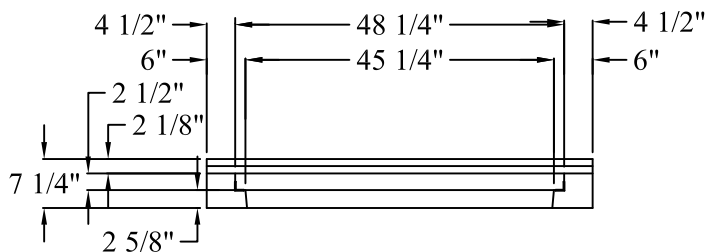

**Continental  
Concrete  
Products, Inc.**  
1 South Grosstown Rd.  
Pottstown, PA 19464  
Phone: (610) 327-3700  
Fax: (610) 327-9488

**PENN D.O.T. 4FT. TYPE S INLET TOP**

<b>DATE:</b> 2-00	<b>SIGNATURE OF APPROVAL</b>	<b>DWG NO.</b> CTLST0017	<b>NAME:</b> BTH
----------------------	------------------------------	-----------------------------	---------------------